

| LOC |               | DIST |         | REVISIONS |     |      |  |
|-----|---------------|------|---------|-----------|-----|------|--|
| AA  | 00            | REV  | DATE    | BY        | CHK | APPV |  |
| C   | ECO-07-017784 |      | 10AUG07 | LAM       | PR  |      |  |

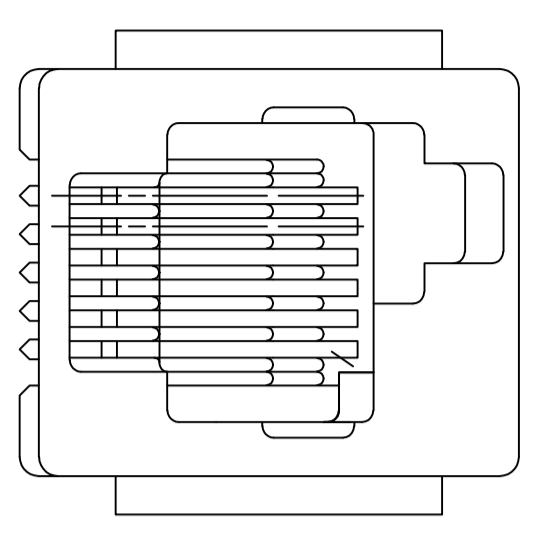

1. MATERIAL:  
 HOUSING- PBT POLYESTER, GRAY.  
 TERMINAL- 0.36μm[.014] THICK PHOS BRONZE  
 PLATED WITH 1.27μm[.000050] MINIMUM THICK  
 HARD GOLD LOCALIZED GOLD PLATE AREA AND  
 3.81μm[.000150] MINIMUM THICK MATTE TIN IN  
 SOLDER AREA OVER 1.27μm[.000050] MINIMUM  
 THICK NICKEL UNDERPLATE.

2. CAVITY CONFORMS TO FCC RULES AND REGULATIONS  
 PART 68 AND REA BULLETIN 345-81, PE-76 SPECIFICATION  
 FOR MODULAR TELEPHONE HARDWARE

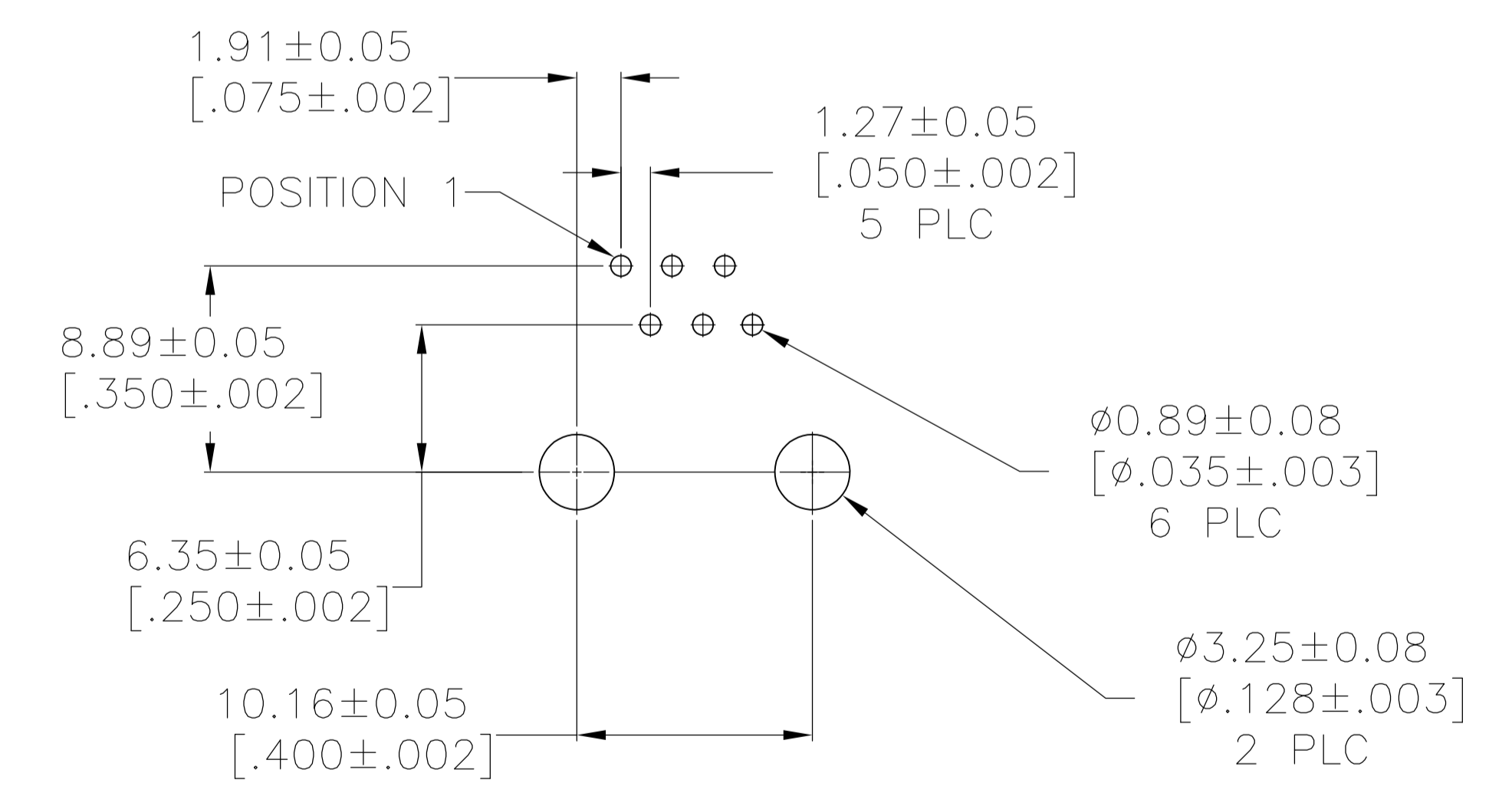
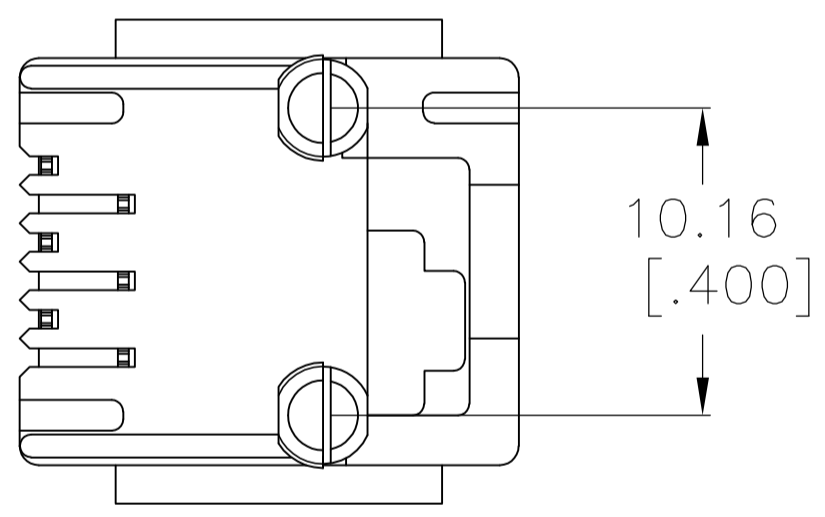
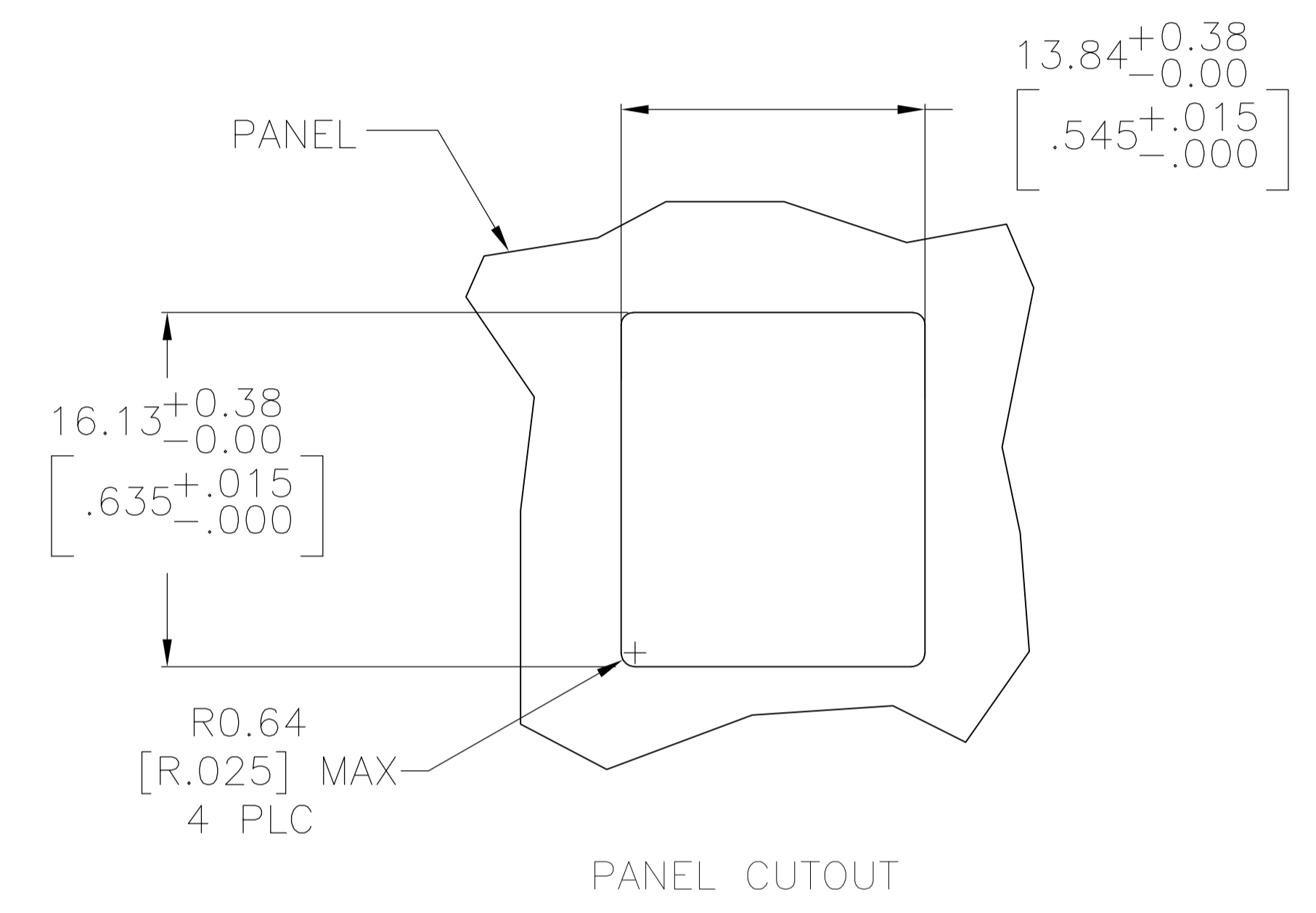
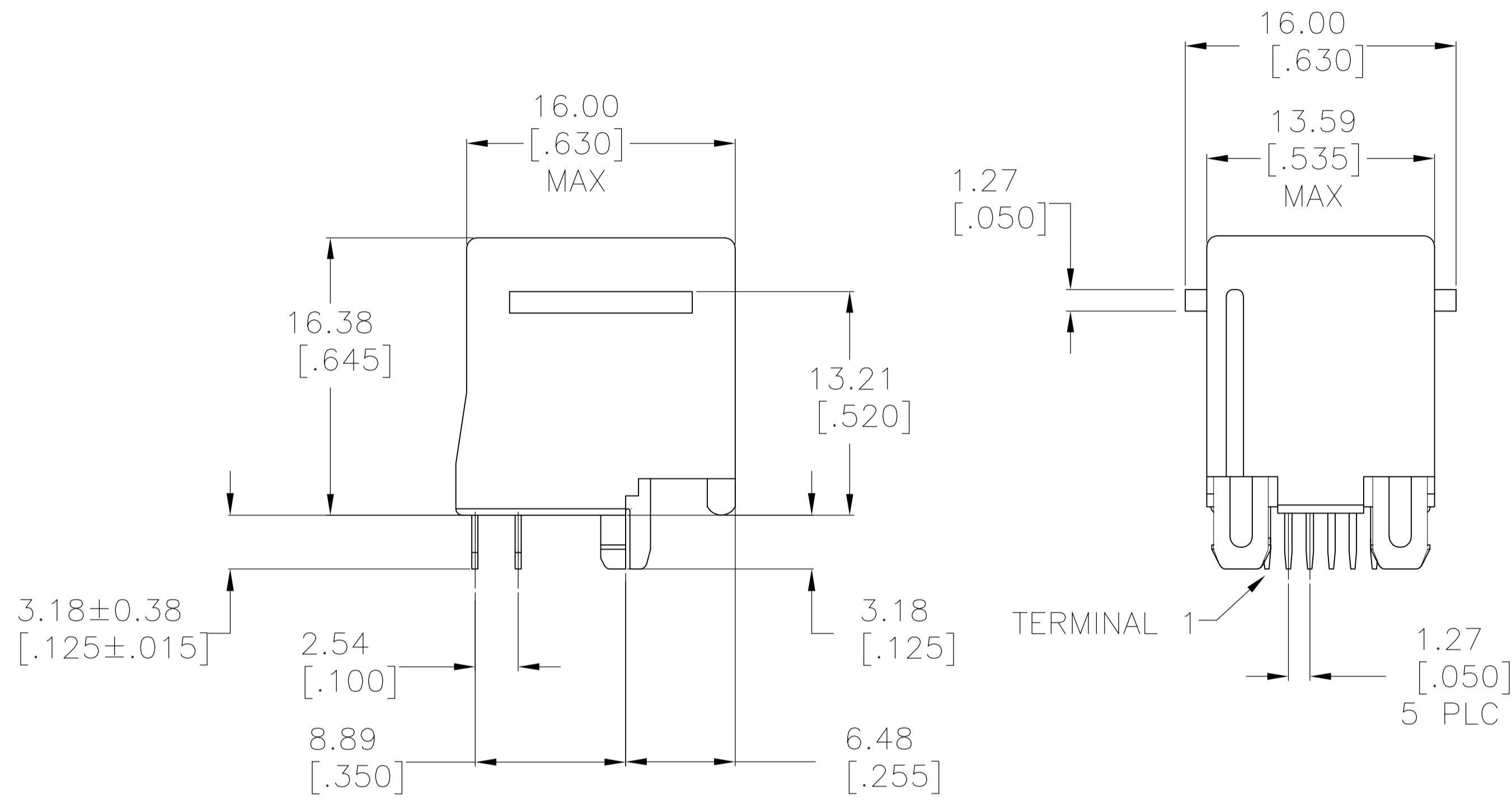

SUGGESTED PRINTED CIRCUIT BOARD LAYOUT  
 COMPONENT SIDE

5554990-1  
 PART NO

|  |              |                  |           |   |  |
|--|--------------|------------------|-----------|---|--|
| THIS DRAWING IS A CONTROLLED DOCUMENT. |              | DIN              | 15AJG2007 | Tyco Electronics Corporation<br>Harrisburg, PA 17105-3608                                   |  |
| DIMENSIONS:<br>mm [INCHES]             |              | CHK              | 15AJG2007 | NAME  |  |
| TOLERANCES UNLESS OTHERWISE SPECIFIED: |              | APVD             | 15AJG2007 | MODULAR JACK ASSEMBLY, TOP ENTRY,<br>6 POSITION, FLANGELESS,<br>W/ PANEL STOPS, RIGHT LATCH |  |
| 0 PLC                                  | ± .00        | PRODUCT SPEC     |           | 108-1163  |  |
| 1 PLC                                  | ± .01        | APPLICATION SPEC |           | 114-2048  |  |
| 2 PLC                                  | ± 0.13[.005] | SIZE             |           | A1  |  |
| 3 PLC                                  | ± .00        | CAGE CODE        |           | 00779   |  |
| 4 PLC                                  | ± .00        | DRAWING NO       |           | 5554990   |  |
| ANGLES                                 | ± .00        | WEIGHT           |           | -   |  |
| MATERIAL                               | SEE NOTE 1   | FINISH           |           | SEE NOTE 1  |  |
| CUSTOMER DRAWING                       |              | SCALE            |           | 4:1   |  |
|  |              | SHEET            |           | 1 OF 1  |  |
|  |              | REV              |           | C   |  |